

# STUDENT SCHEDULE PLANNER

## 1 LOGIN

Go to [myzou.missouri.edu](http://myzou.missouri.edu)  
Log In, Click Student Center,  
Click "Schedule Planner"

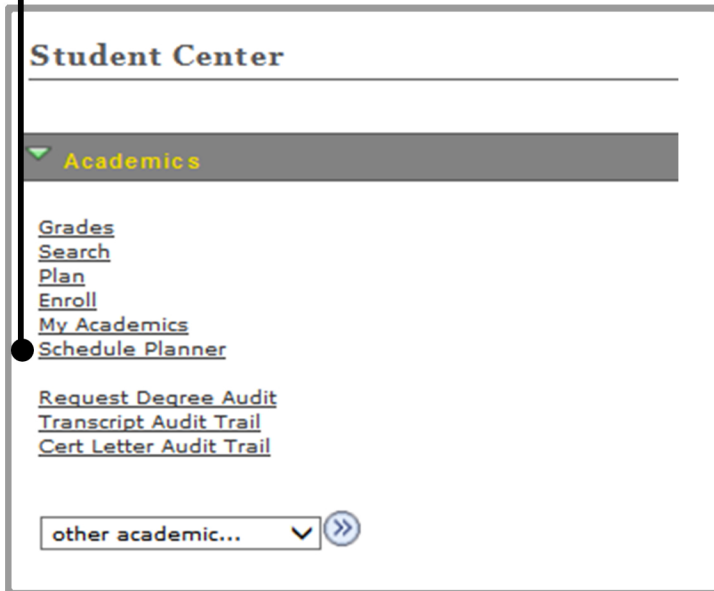

## 2 CLICK "SCHEDULE PLANNER"

"Click Here" To Easily Plan Your  
Class Schedule

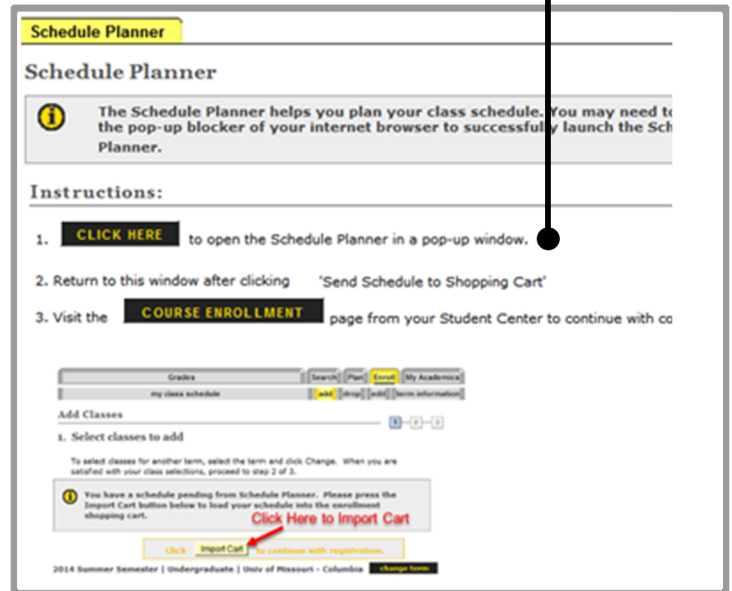

## 3 ADD COURSES

To Take Next Term

## 4 ADD BREAKS

To Block Off Times  
For No Class

## 5 GENERATE

All Possible Schedules

## 6 VIEW

To See Each Schedule

## 7 SEND TO SHOPPING CART

From the "View" Screen, Click the "Shopping Cart" Button to Begin Registration!

